

velomount Spacy

12V SPACE-SAVING, HIGH PERFORMANCE TYRE CHANGER FOR MOBILE USE

The velomount Spacy is the new generation of tyre fitting equipment specifically designed for use inside a mobile fitting operation.

On face value, the concept and design may look similar to existing products on the market, however we are in no doubt that, with the 'Spacy' we have ticked even more boxes and taken the performance / weight / space factors to a completely different level! After some intense design brainstorming from our clever R&D team, we have managed to make this machine lower and more compact than any comparable products on the market, without compromising in any way the performance or capability of the machine. Through years of working with mobile installations and talking to the people who matter (we even employed an experienced mobile tyre technician for this project!), we have understood what really matters for both the operator, and the people tasked with kitting out vehicles. The result is, in our opinion, the best all-round tyre changer ever designed for mobile use.

KEY FEATURES

- Low maximum height of just 1900mm
- Ingenious design swings either left or right to suit the location on the vehicle
- Leverless as standard (traditional demount head also available)
- Compact, versatile 'assist' arms can be configured to suit vehicle/operator
- Available in either red or blue



UNRIVALLED FOR SPACE v PERFORMANCE!

Actual machine dimensions are subjective and depend on the positioning in the vehicle and the chosen configuration/assist arm options; we suggest talking to one of our technical representatives. As a guide, the machine absorbs **a minimum of 1330mm deep, 1140mm wide and 1900mm high**, but this can increase with additional accessories. However, even 'fully loaded', with both SP1 and SP2 arms, the minimum width requirement only increases to an amazing 1500mm!

SPECIFICATIONS

Clamping range:	10" to 24" (External) 12" to 26" (Internal)
Max tyre diameter:	39"
Max tyre width:	15"
Motor power:	12V / 400W / 1 speed
Net weight (excl acc):	230 kg

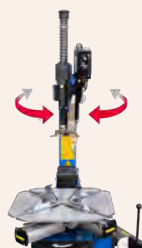

Column can be set to swing left or right



SP1 Bead Press / Lifter



SP2 'Dynamic' Bead Press



Twin Assist Arms