

# VSX3500-LP

## FULL-RISE, SHORT PLATFORM, LOW PROFILE SCISSOR LIFT

The VSX3500-LP is a very well-priced ultra low-profile, full-height scissor, boasting a 3500KG capacity, completely clear area for working between structures, and the inclusion of our SureFast hidden-locking design which enables the lift to be positioned at any height as opposed to pre-determined positions due to external mechanical locks.



### KEY FEATURES

- 3,500Kg capacity lift ideal for fast tyre replacement and brake service work
- Sleek, ultra low-profile design, no in-ground installation required
- Double master/slave hydraulic circuits and "Magic Eye" photocell assures perfect synchronization
- Hydraulic interlock means the lift can be locked at the desired height
- Secure and reliable
- Emergency manual lowering in the event of power loss

A manual emergency lowering system in the event of a power outage and neat, compact control console complete the high specification. Includes 4 x Rubber Blocks.

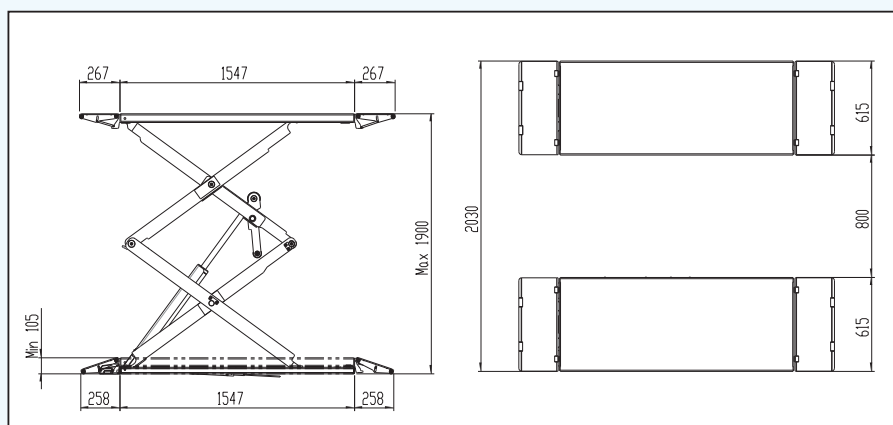

### SPECIFICATIONS

Lifting capacity:	3,500kg
Max Lifting Height:	1,900mm
Min Height:	105mm
Platform Length:	1,547mm-2,080mm
Lifting Time:	60 seconds
Power Supply:	230V 1Ph / 400V 3Ph
Motor Power	2.2kW / 2.6kW